

Drain: CROOKED CREEK DRAIN Drain #: 250  
 Improvement/Arm: ASH BROOKE - SECTION 3  
 Operator: JDH Date: 11-25-03  
 Drain Classification: Urban/Rural Year Installed: 1995

### GIS Drain Input Checklist

- Pull Source Documents for Scanning JDH 11-25
- Digitize & Attribute Tile Drains N/A
- Digitize & Attribute Storm Drains JDH 11-25
- Digitize & Attribute SSD JDH 11-25
- Digitize & Attribute Open Ditch N/A
- Stamp Plans JDH 11-25
- Sum drain lengths & Validate JDH 11-25
- Enter Improvements into Posse JDH 11-25
- Enter Drain Age into Posse JDH
- Sum drain length for Watershed in Posse JDH
- Check Database entries for errors JDH 11-25





SURVEYOR'S OFFICE

# Hamilton County

Kenton C. Ward, Surveyor  
776-8495

Suite 146  
One Hamilton County Square  
Noblesville, Indiana 46060-2230

TO: Hamilton County Drainage Board

RE: CROOKED CREEK DRAIN [REDACTED]  
ASHBROOKE SEC 3

Attached are as-builts, certificate of completion & compliance, and other information for ASHBROOKE SEC 3. An inspection of the drainage facilities for this section has been made and the facilities were found to be complete and acceptable.

During construction, changes were made to the drain which will alter the plans submitted with my report for this drain dated 11-30-94. The changes are as follows:

over →

The length of the drain due to the changes described above is now 4629 feet.

~~During construction of the drain there were not any significant changes made to the plans submitted with my report dated \_\_\_\_\_ . Therefore, the length of the drain remains at \_\_\_\_\_ feet.~~

~~Attached also is a non-enforcement for the drain which I recommend that the Board approve at this time. The non-enforcement was approved by the Board at its meeting on 1-23-95.~~

The bond or letter of credit from Brewick Dev. Co. was not required. ~~number \_\_\_\_\_, dated \_\_\_\_\_, in the amount of \_\_\_\_\_, has been recommended for release in a letter to the Commissioners dated \_\_\_\_\_.~~

I recommend the Board approve the drains construction as complete and acceptable.

Sincerely,

\_\_\_\_\_  
Kenton C. Ward,  
Hamilton County Surveyor

KCW/jh

The 6" SSD was incorrectly reported. The total length of 6" SSD is 2899 feet. STR 104-105 was incorrectly reported as 30" RCP. ~~TL~~ The correct RCP is 24" at 28' feet.

STR 101-102	30" RCP	shortened from 92' feet to 75' feet.
STR 103-104	30" RCP	lengthened from 167' feet to 168' feet.
STR 106-107	12" RCP	shortened from 371' feet to 370' feet.
STR 109-110	18" RCP	shortened from 26' feet to 24' feet.
STR 110-111	18" RCP	lengthened from 164' feet to 165' feet.
STR 111-112	12" RCP	shortened from 264' feet to 262' feet.
STR 113-114	15" RCP	shortened from 165' feet to 165' feet.
STR 114-115	15" RCP	shortened from 30' feet to 28' feet.

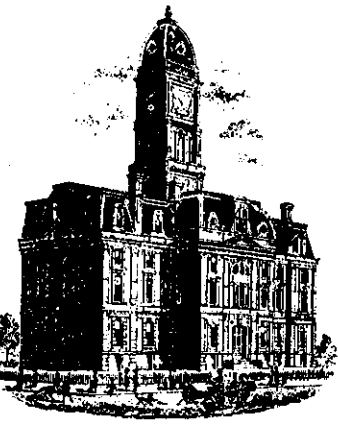

SURVEYOR'S OFFICE

# Hamilton County

Kenton C. Ward, Surveyor  
776-8495

Suite 146  
One Hamilton County Square  
Noblesville, Indiana 46060-2230

November 30, 1994

TO: Hamilton County Drainage Board

RE: Crooked Creek Drain-Ashbrooke Arm-Section 3 and 4

Attached is a petition, non-enforcement request, plans, calculations, quantity summary, and assessment roll for the Ashbrooke Arm-Section 3 and 4 -Crooked Creek Drain. I have reviewed the submittals and petition and have found each to be in proper form.

I have made a personal inspection of the land described in the petition. Upon doing so, I believe that the drain is practicable; will improve the public health; benefit a public highway and be of public utility; and that the costs, damages and expenses of the proposed drain will probably be less than the benefits accruing to the owners of land likely to be benefited. The drain will consist of the following:

Ashbrooke-Section 3

6"	SSD	2894 feet	24"	RCP	376 feet
12"	RCP	635 feet	30"	RCP	352 feet
15"	RCP	194 feet			
18"	RCP	190 feet			

Ashbrooke-Section 4

6"	SSD	2786 feet	30"	RCP	249 feet
15"	RCP	247 feet	36"	RCP	176 feet
18"	RCP	103 feet			

The length of drain in Section 3 is 4648 feet and in Section 4 3561 feet.

The total length of the drain will be 8209 feet for both sections.

The retention pond (lake) located in the common areas is not to be considered part of the regulated drain. Only the inlet and outlet will be maintained as part of the regulated drain. The maintenance of the pond (lake) will be the responsibility of the Homeowners Association. The Board will however, retain jurisdiction for ensuring the storage volume for which the lake was designed will be retained. Thereby, allowing no fill or easement encroachments.

The subsurface drains (SSD) to be part of the regulated drain are those located under the curbs and those main lines between lots or in rear yards. Only the main SSD lines which are located within the right of way are to be maintained as regulated drain. Laterals for individual lots will not be considered part of the regulated drain.

I have reviewed the plans and believe the drain will benefit each lot equally. Therefore, I recommend each lot be assessed equally. I also believe that no damages will result to landowners by the construction of this drain. I recommend a maintenance assessment of \$30.00 per lot, \$5.00 per acre for roadways, with a \$30.00 minimum. With this assessment the total annual assessment for this drain/this section will be \$ 1440.00 .

I believe this proposed drain meets the requirements for Urban Drain Classification as set out in IC 36-9-27-67 to 69. Therefore, this drain shall be designated as an Urban Drain.

I recommend that upon approval of the above proposed drain that the Board also approve the attached non-enforcement request. This request is for the reduction of the regulated drain easement to those easement widths as shown on the secondary plat for Ashbrooke-Section 3 & 4 as recorded in the office of the Hamilton County Recorder.

I recommend the Board set a hearing for this proposed drain for January 1995.

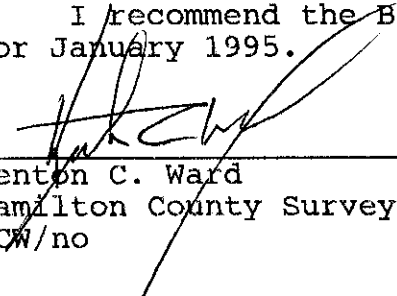
  
Kenton C. Ward  
Hamilton County Surveyor  
KCW/no



2. The Petitioner shall retain the Engineer throughout the construction phase. At completion of the project the Petitioners Engineer shall certify that the drainage system which is to be maintained as a regulated drain has been constructed as per construction plans.
  
3. The Petitioner shall request all changes from the approved plan prior to implementation of the change. All changes shall be documented and given to the Surveyor to be placed in the Drain file.
  
4. The Petitioner shall instruct his Engineer to provide a reproducible print on a 24" x 36" mylar of the final design of the Drainage System. This shall be submitted prior to the release of the Performance Bond.
  
5. The Petitioner shall comply with the Erosion Control Plan as specified on the construction plans. Failure to comply with the Erosion Control Plan shall be determined by the Board as being an obstruction to the drainage system. The Surveyor shall immediately install or repair the needed measures as per IC 36-9-27-46.

The Petitioner further requests that the Drain be classified as an Urban Drain.

x  \_\_\_\_\_  
 SIGNED

George Sweet  
 \_\_\_\_\_  
 PRINTED NAME

\_\_\_\_\_  
 SIGNED

\_\_\_\_\_  
 PRINTED NAME

RECORDED OWNER (S) OF LAND INVOLVED

DATE \_\_\_\_\_, 19\_\_\_\_



## ENGINEERS ESTIMATE

PROJECT: ASHBROOKE 3

DATE: 9-9-94

LOCATION:

ITEM: STORM

JOB #: 813

DESCRIPTION	QUANTITY	UNIT	UNIT PRICE	TOTAL
12" RCP PIPE	632	LF	\$15.00	\$9,480.00
15" RCP PIPE	193	LF	\$17.00	\$3,281.00
18" RCP PIPE	192	LF	\$20.00	\$3,840.00
21" RCP PIPE		LF	\$22.00	\$0.00
24" RCP PIPE	404	LF	\$25.00	\$10,100.00
27" RCP PIPE		LF	\$30.00	\$0.00
30" RCP PIPE	312	LF	\$34.00	\$10,608.00
33" RCP PIPE		LF	\$39.00	\$0.00
36" RCP PIPE		LF	\$43.00	\$0.00
42" RCP PIPE		LF	\$53.00	\$0.00
INLET/BEEHIVES	12	EA	\$850.00	\$10,200.00
MANHOLES	1	EA	\$1,600.00	\$1,600.00
12" END SECTION		EA	\$275.00	\$0.00
15" END SECTION		EA	\$300.00	\$0.00
18" END SECTION		EA	\$350.00	\$0.00
24" END SECTION		EA	\$400.00	\$0.00
30" END SECTION	1	EA	\$425.00	\$425.00
33" END SECTION		EA	\$450.00	\$0.00
36" END SECTION		EA	\$475.00	\$0.00
42" END SECTION		EA	\$500.00	\$0.00
GRANULAR BACKFILL	600	CYDS	\$8.50	\$5,100.00
6" SUBSURFACE	2850	LF	\$4.25	\$12,112.50
4" SUBSURFACE LOT HOOKUPS	250	LF	\$4.00	\$1,000.00
<b>TOTAL STORM</b>				<b>\$67,746.50</b>

CERTIFICATE OF COMPLETION AND COMPLIANCE

TO: HAMILTON COUNTY SURVEYOR  
RE: ASHBROOKE SECTION FOUR

I hereby certify that:

- 1.) I am a Registered Engineer in the State of Indiana,
- 2.) I am familiar with the plans and specifications for the above referenced subdivision,
- 3.) I have personally observed and supervised the completion of the Drainage Facilities for the above referenced subdivision, and
- 4.) To the best of my knowledge, information and belief, the Drainage Facilities within the subdivision has been installed and completed in conformity with all plans and specifications,

Signature: *Duane A. Sharrer* Date: August 31, 1994

Type or Printed Name: Duane A. Sharrer

Business Address: 3020 North Post Road  
Indianapolis, IN 46226

Telephone: 317-898-8282

INDIANA REGISTRATION NUMBER

890258

SEAL

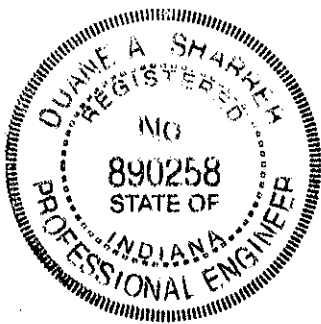

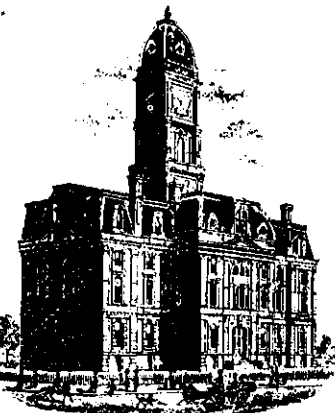

SURVEYOR'S OFFICE

# Hamilton County

Kenton C. Ward, Surveyor  
 Phone (317) 776-8495  
 Fax (317) 776-9628

Suite 146  
 One Hamilton County Square  
 Noblesville, Indiana 46060-2230  
 July 24, 1996

To: Hamilton County Drainage Board

Re: Crooked Creek Drain  
 Ashbrooke Section 3

Attached are as-builts, certificate of completion & compliance, and other information for Ashbrooke Section 3. An inspection of the drainage facilities for this section has been made and the facilities were found to be complete and acceptable.

During construction, changes were made to the drain which will alter the plans submitted with my report for this drain dated November 30, 1994. The changes are as follows:

- The 6" SSD was incorrectly reported. The total length of 6" SSD is 2899 feet.
- STR 104-105 was incorrectly reported as 30" RCP. The correct RCP is 24" at 28' feet.
- STR 101-102 30" RCP Shortened from 92' feet to 75' feet.
- STR 103-104 30" RCP Lengthened from 167' feet to 168' feet.
- STR 106-107 12" RCP Shortened from 371' to 370' feet.
- STR 109-110 18" RCP Shortened from 26' feet to 24' feet.
- STR 110-111 18" RCP Lengthened from 164' feet to 165' feet.
- STR 111-112 12" RCP Shortened from 264' feet to 262' feet.
- STR 113-114 15" RCP Shortened from 166' feet to 165' feet.
- STR 114-115 15" RCP Shortened from 30' feet to 28' feet.

The length of the drain due to the changes described above is now <sup>4623</sup>4629 feet.

The non-enforcement was approved by the Board at its meeting on January 23, 1995.

The bond or letter of credit from Brenwick Development Co. was not required.

I recommend the Board approve the drains construction as complete and acceptable.

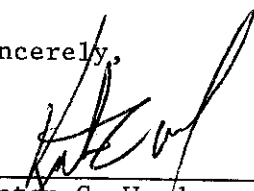
Sincerely,  
  
 \_\_\_\_\_  
 Kenton C. Ward  
 Hamilton County Surveyor

KCW/ndw

SECTION 7-T17N-R3E

# ASHBROOKE SECTIONS 3 & 4

(CONSTRUCTION PLANS)

## CLAY TOWNSHIP HAMILTON COUNTY, INDIANA

DEVELOPER:

**BRENNICK DEVELOPMENT CO., INC.**

9502 ANGOLA COURT  
INDIANAPOLIS, INDIANA 46268  
(317) 841-9102

Engineer:

**SCHNEIDER ENGINEERING CORP.**

3020 NORTH POST ROAD  
INDIANAPOLIS, INDIANA 46226  
(317) 898-8282 FAX (317) 899-8010

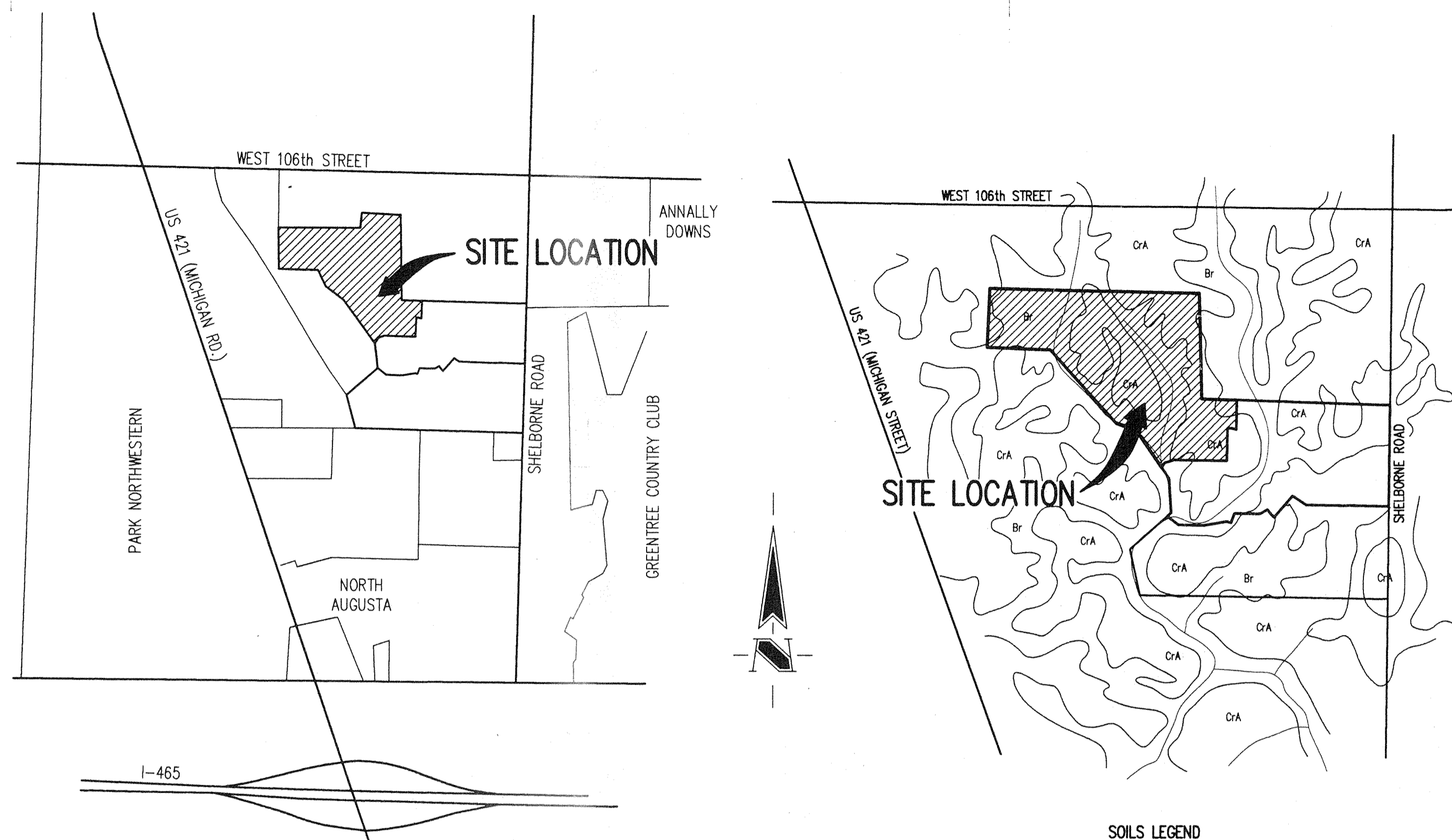

**SOILS LEGEND**  
CrA - Crosby Silt Loam  
Br - Brookston-Silty Clay Loam

**AREA MAP**  
NOT TO SCALE

**SOILS MAP**  
NOT TO SCALE

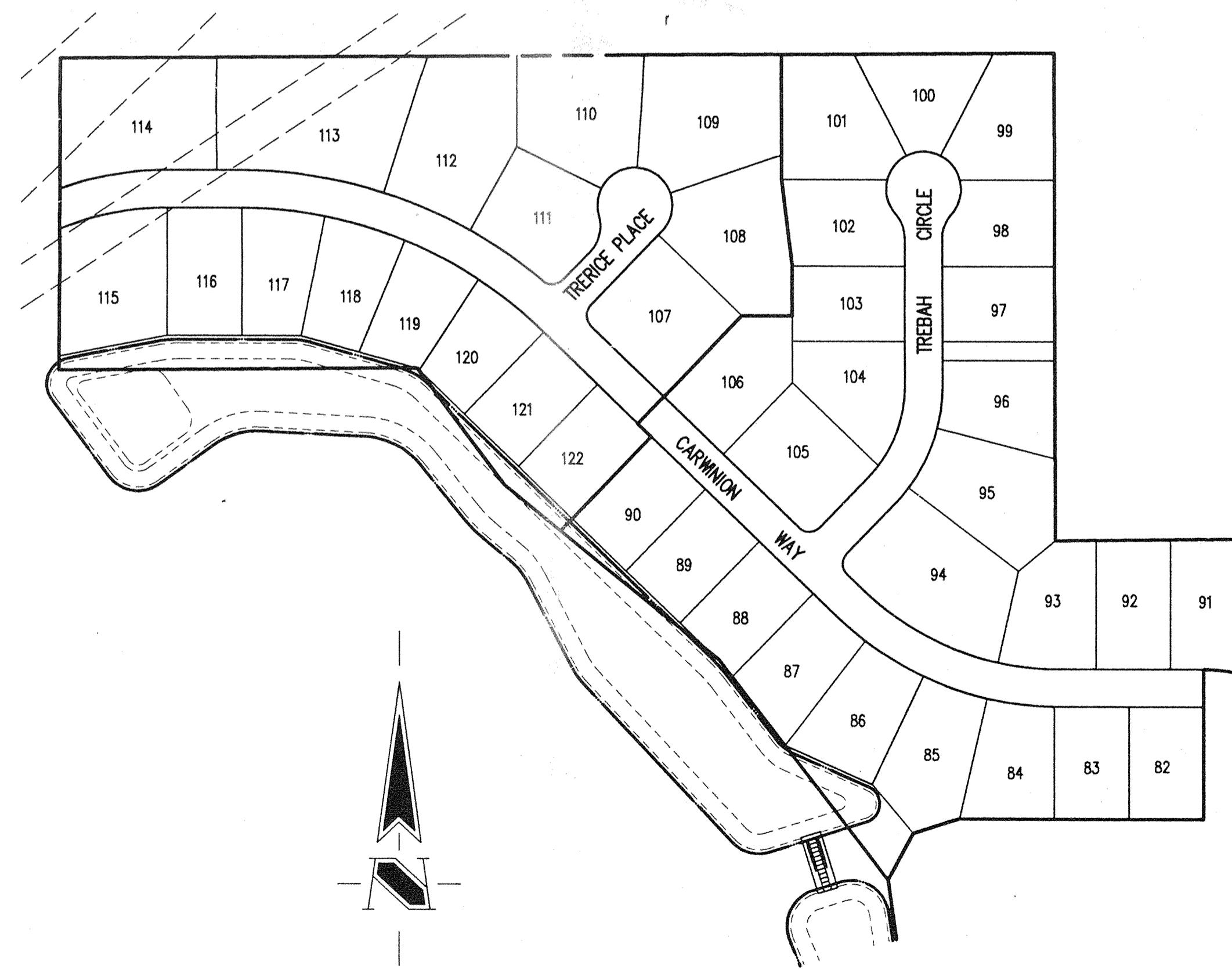

**SITE MAP**  
SCALE: 1"=150'

INDEX	
SHEET No.	DESCRIPTION
S-1	COVER SHEET
S-2	DEVELOPMENT PLAN-SECTION 3
S-3	DEVELOPMENT PLAN-SECTION 4
S-4	EROSION CONTROL PLAN-SECTION 3
S-5	EROSION CONTROL PLAN-SECTION 4
S-6	STREET PLAN
S-7	STREET PLAN
S-8	STREET PLAN
S-9	INTERSECTION & CUL-DE-SAC DETAILS
S-10	SANITARY SEWER PLAN
S-11	SANITARY SEWER PLAN
S-12	STORM SEWER PLAN
S-13	STORM SEWER PLAN
S-14	STORM SEWER PLAN
S-15	GENERAL DETAILS
S-16	SPECIFICATIONS

This information was gathered for input into the Hamilton County Geographic Information System. This information is considered an official record of the GIS.  
Entry Date: 11-25-93  
Entered by: JDL

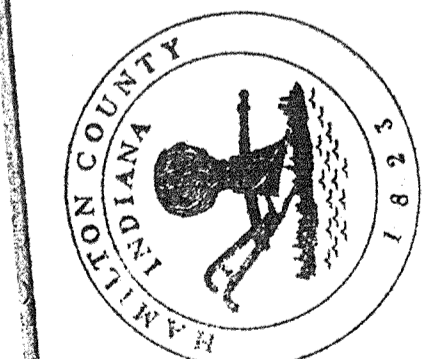

**Schneider Engineering Corporation**  
PROFESSIONAL ENGINEERS-LAND SURVEYORS-LAND PLANNERS-GEOLOGISTS

INDIANAPOLIS: 3020 NORTH POST ROAD, INDIANAPOLIS, INDIANA 46226-6518, Telephone (317) 898-8282 FAX (317) 899-8010  
AVON: 6845 EAST U.S. 36, SUITE 500, DANVILLE, INDIANA 46122, Telephone (317) 272-0108 FAX (317) 272-0412

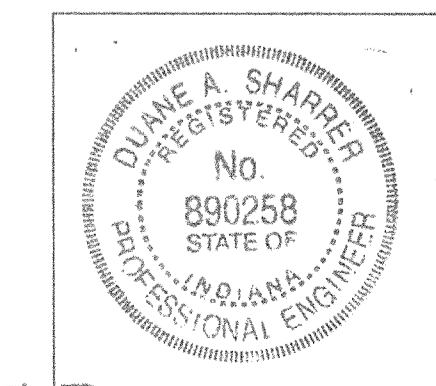

CERTIFIED BY: *Duane A. Shaver* FILED DATE: 2/30/94

PROJECT ENGINEER: DKS  
CHECKED BY: \_\_\_\_\_ DATE CHECKED: 4/27/93

SEP 09 1994  
OFFICE OF HAMILTON COUNTY SURVEYOR  
(JOB No. 813.30)

RECORD DRAWING

SHEET 1 OF 17

**Benchmarks**

**NOTE:**  
The elevation datum used for this project was formulated to coincide with topographic mapping created from aerial photography. This mapping was prepared by a consultant using an incorrect elevation value for USCGS Benchmark T-78. Since this mapping USCGS Benchmark T-78 has been destroyed. Previous surveys have established that a discrepancy existed between USCGS Benchmarks T-78 and S-78. The combination of these situations results in establishing an elevation datum based on an elevation value 1.12 feet greater than the published value for USCGS Benchmark S-78. The following benchmarks are established on site with values adjusted for use with this project only.

**TBM 101**  
Top of railroad spike in centerline of Shelbourne Road approximately 1335 feet south of the centerline of 106th Street.  
Elevation = 890.98

**TBM 102**  
Top of boat spike in centerline of Shelbourne Road approximately 2600 feet south of the centerline of 106th Street.  
Elevation = 885.42

**TBM 103**  
P.K. nail in west side of power pole 1 foot up on the east side of Shelbourne Road approximately 2600 feet south of the centerline of 106th Street.  
Elevation = 886.54

**TBM 104**  
A cut square at the southeast corner of the concrete deck of a lift station on the south side of the subject site approximately 1600 feet west of the centerline of Shelbourne Road.  
Elevation = 884.12

**LEGEND**

- Existing Storm Sewer
- New Storm Sewer
- Existing Sanitary Sewer w/Existing Laterals  
Existing Laterals running to the opposite side of the street will be extended prior to construction of street.
- New Sanitary Sewer  
(Laterals are shown for reference only  
See Sanitary Plan & Profiles for Locations)
- Existing Contour
- Existing Elevation
- New Pavement Grade
- All Other Finish Grades
- Corrected Grades
- Storm Structure Number.....
- Sanitary Structure Number
- Flow Arrow
- Denotes Elevation and Approximate Pad Size
- Swale (fl)
- Swale
- 6" Subsurface Drain w/4" Lateral Connection
- Suggested Finish Floor Elevation

**000 SANITARY SEWER TABLE**

STR #	STA	BASE LINE	OFFSET	LT/RT	TYPE	TC	INVERTS
1	19+20	A	40'	LT	MANHOLE	886.6	879.15 (SE) 879.15 (NE)
2	21+50	A	35'	LT	MANHOLE	888.0	880.00 (S) 880.00 (N)
3	25+50	A	30'	LT	MANHOLE	889.0	882.25 (S) 882.25 (NW & NE)
4	27+27	A	30'	LT	MANHOLE	891.0	883.10 (SE) 883.20 (NW)
5	29+37	A	40'	LT	MANHOLE	888.8	884.09 (SE) 884.19 (W)
6	31+37	A	30'	LT	MANHOLE	889.9	885.06 (E)
7	2+32	B	2'	LT	MANHOLE	886.8	881.56 (SW) 881.66 (N)
8	2+32	B	2'	LT	MANHOLE	890.2	883.28 (S)
9	2+32	B	6.8'	RT	MANHOLE	891.9	882.58 (SW)

**000 STORM SEWER TABLE**

STR #	STA	BASE LINE	OFFSET	LT/RT	TYPE	TC	INVERTS
101	18+82	A	311'	LT	SLOPE WALL		879.00 (NE)
102	18+74	A	220'	LT	MANHOLE	884.9	879.59 (SW & E)
103	18+35	A	182'	LT	MANHOLE	884.2	879.71 (W & N)
104	18+30	A	15'	LT	CURB INLET	885.67	880.41 (S & N)
105	18+30	A	15'	RT	CURB INLET	885.67	880.52 (S & N)
106	17+80	A	189'	RT	BEEHIVE INLET	884.8	881.07 (SW) 881.78 (W)
107	4+50	B	160'	RT	BEEHIVE INLET	888.0	884.60 (S)
108	17+80	A	160'	RT	BEEHIVE INLET	886.2	880.94 (S)
109	1+60	B	13'	RT	CURB INLET	885.46	885.00 (SE) 885.00 (NW)
110	1+60	B	13'	LT	CURB INLET	885.46	885.00 (SE) 885.00 (NW)
111	2+87	B	170'	LT	BEEHIVE INLET	886.9	886.35 (SE) 883.75 (N)
112	5+54	B	183'	LT	BEEHIVE INLET	889.2	886.05 (S)
113	24+00	A	181'	LT	SLOPE WALL		883.00 (NE)
114	24+00	A	15'	LT	CURB INLET	889.09	885.40 (SW & NE)
115	24+00	A	15'	LT	CURB INLET	889.09	885.47 (SW)
116	26+01	A	181'	LT	SLOPE WALL		883.00 (NE)
117	25+98.03	A	15'	LT	CURB INLET	890.28	886.28 (SW & NE)
118	0+38.87	A	13'	LT	CURB INLET	889.90	886.43 (SW & SE)
119	1+50	A	13'	RT	CURB INLET	889.90	886.49 (NW)
120	1+50	A	206'	LT	UNDERWATER DISCHARGE		879.66 (N)
121	29+50	A	15'	LT	CURB INLET	888.22	883.39 (S & N)
122	29+50	A	15'	RT	CURB INLET	888.22	883.77 (S)
123	28+74	A	30'	RT	MANHOLE	889.8	882.99 (SW & N)
124	28+74	A	170'	RT	SPECIAL INLET		883.92 (S)
125	28+53	A	30'	LT	MANHOLE	888.5	880.15 (S) 882.40 (NE) 883.20 (N)

SEE PROFILE SHEETS

SEE PROFILE SHEETS

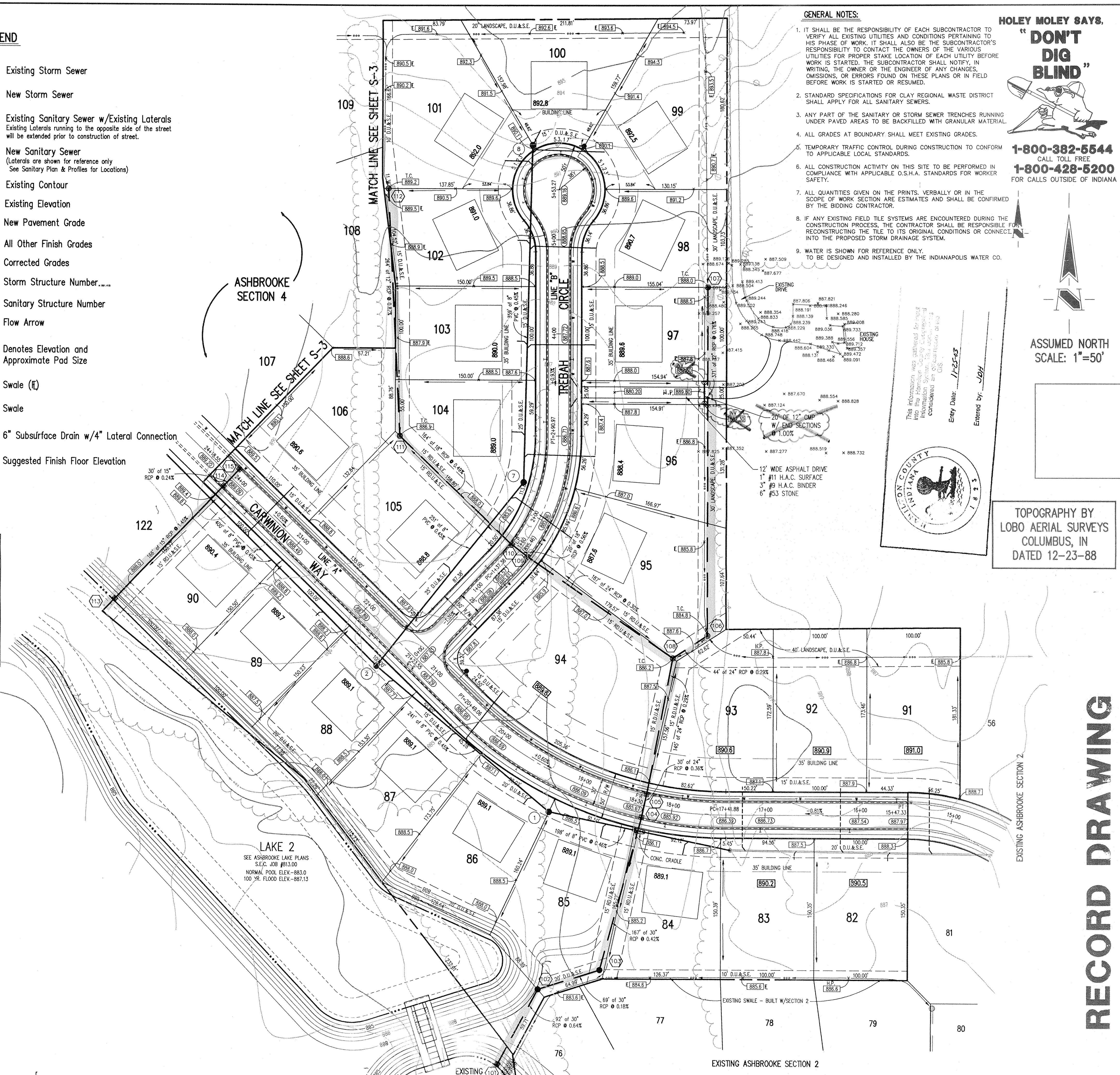

- GENERAL NOTES:**
- IT SHALL BE THE RESPONSIBILITY OF EACH SUBCONTRACTOR TO VERIFY ALL EXISTING UTILITIES AND CONDITIONS PERTAINING TO HIS PHASE OF WORK. IT SHALL ALSO BE THE SUBCONTRACTOR'S RESPONSIBILITY TO CONTACT THE OWNERS OF THE VARIOUS UTILITIES FOR PROPER STAKE LOCATION OF EACH UTILITY BEFORE WORK IS STARTED. THE SUBCONTRACTOR SHALL NOTIFY, IN WRITING, THE OWNER OR THE ENGINEER OF ANY CHANGES, OMISSIONS, OR ERRORS FOUND ON THESE PLANS OR IN FIELD BEFORE WORK IS STARTED OR RESUMED.
  - STANDARD SPECIFICATIONS FOR CLAY REGIONAL WATER DISTRICT SHALL APPLY FOR ALL SANITARY SEWERS.
  - ANY PART OF THE SANITARY OR STORM SEWER TRENCHES RUNNING UNDER PAVED AREAS TO BE BACKFILLED WITH GRANULAR MATERIAL.
  - ALL GRADES AT BOUNDARY SHALL MEET EXISTING GRADES.
  - TEMPORARY TRAFFIC CONTROL DURING CONSTRUCTION TO CONFORM TO APPLICABLE LOCAL STANDARDS.
  - ALL CONSTRUCTION ACTIVITY ON THIS SITE TO BE PERFORMED IN COMPLIANCE WITH APPLICABLE O.S.H.A. STANDARDS FOR WORKER SAFETY.
  - ALL QUANTITIES GIVEN ON THE PRINTS, VERBALLY OR IN THE SCOPE OF WORK SECTION ARE ESTIMATES AND SHALL BE CONFIRMED BY THE BIDDING CONTRACTOR.
  - IF ANY EXISTING FIELD TILE SYSTEMS ARE ENCOUNTERED DURING THE CONSTRUCTION PROCESS, THE CONTRACTOR SHALL BE RESPONSIBLE FOR RECONSTRUCTING THE TILE TO ITS ORIGINAL CONDITIONS OR CONNECTING INTO THE PROPOSED STORM DRAINAGE SYSTEM.
  - WATER IS SHOWN FOR REFERENCE ONLY. TO BE DESIGNED AND INSTALLED BY THE INDIANAPOLIS WATER CO.

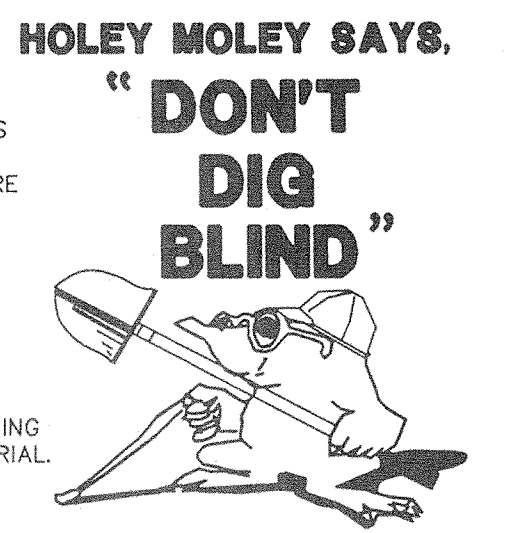

**1-800-382-5544**  
CALL TOLL FREE  
**1-800-428-5200**  
FOR CALLS OUTSIDE OF INDIANA

ASSUMED NORTH  
SCALE: 1"=50'

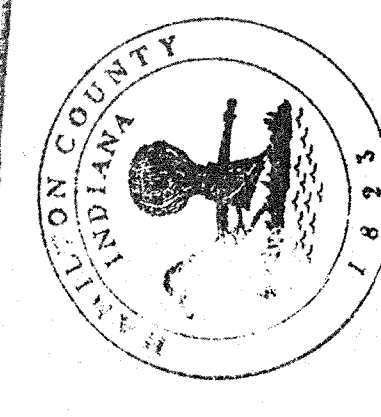

TOPOGRAPHY BY  
LOBO AERIAL SURVEYS  
COLUMBUS, IN  
DATED 12-23-88

**REVISIONS**

NO.	DATE	BY	CHECK
1	12/23/88	JDH	JDH

**SCHEIDT ENGINEERING CORPORATION**  
Professional Engineers • Land Planners  
Land Surveyors • Geologists







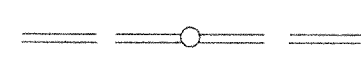

**BRENNICK DEVELOPMENT CO., INC.**  
3020 NORTH POST ROAD - 6516  
INDIANAPOLIS, INDIANA 46128  
Phone: (317) 899-8282 Fax: (317) 899-8010

PROJECT: ASHBROOKE - SECTION 3 & 4  
JOB NO: 813.30  
PREPARED FOR: BRENNICK DEVELOPMENT CO., INC.  
TITLE: DEVELOPMENT PLAN  
SCALE: 1"=50'  
SHEET 3-2 OF 16  
FILE NAME: 81330EVI

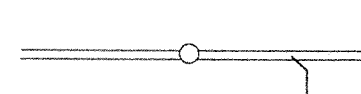
RECORD DRAWING

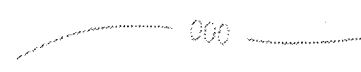
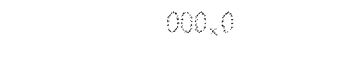
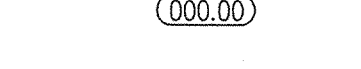
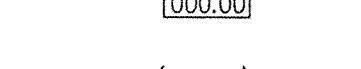
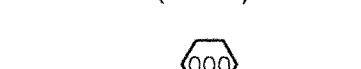
This copy printed from the Digital Archive of the Hamilton County Surveyors Office, One Hamilton Co. Surveyors Office, 188 Noble, Indianapolis, IN 46208

**LEGEND**

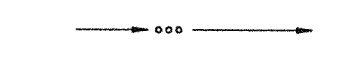
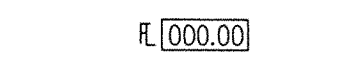
-  Existing Storm Sewer
-  New Storm Sewer
-  Existing Sanitary Sewer w/Existing Laterals
-  New Sanitary Sewer  
(Laterals are shown for reference only  
See Sanitary Plan & Profiles for Locations)
-  Existing Contour
-  Existing Elevation
-  Proposed Grade
-  All Other Finish Grades
-  Curbed Grades
-  Sewer Structure Number
-  Sanitary Structure Number
-  Flow Arrow
-  Denotes Elevation and  
Approximate Pad Size
-  Swale (R)
-  Swale
-  6" Subsurface Drain w/4" Lateral Connection

TOPOGRAPHY BY  
LOBO AERIAL SURVEYS  
COLUMBUS, IN  
DATED 12-23-88

**HOLEY MOLEY SAYS**  
"DON'T  
DIG  
BLIND"  
  
1-800-382-5544  
CALL TOLL FREE  
1-800-428-5200  
FOR CALLS OUTSIDE OF INDIANA

ASSUMED NORTH  
SCALE: 1"=50'

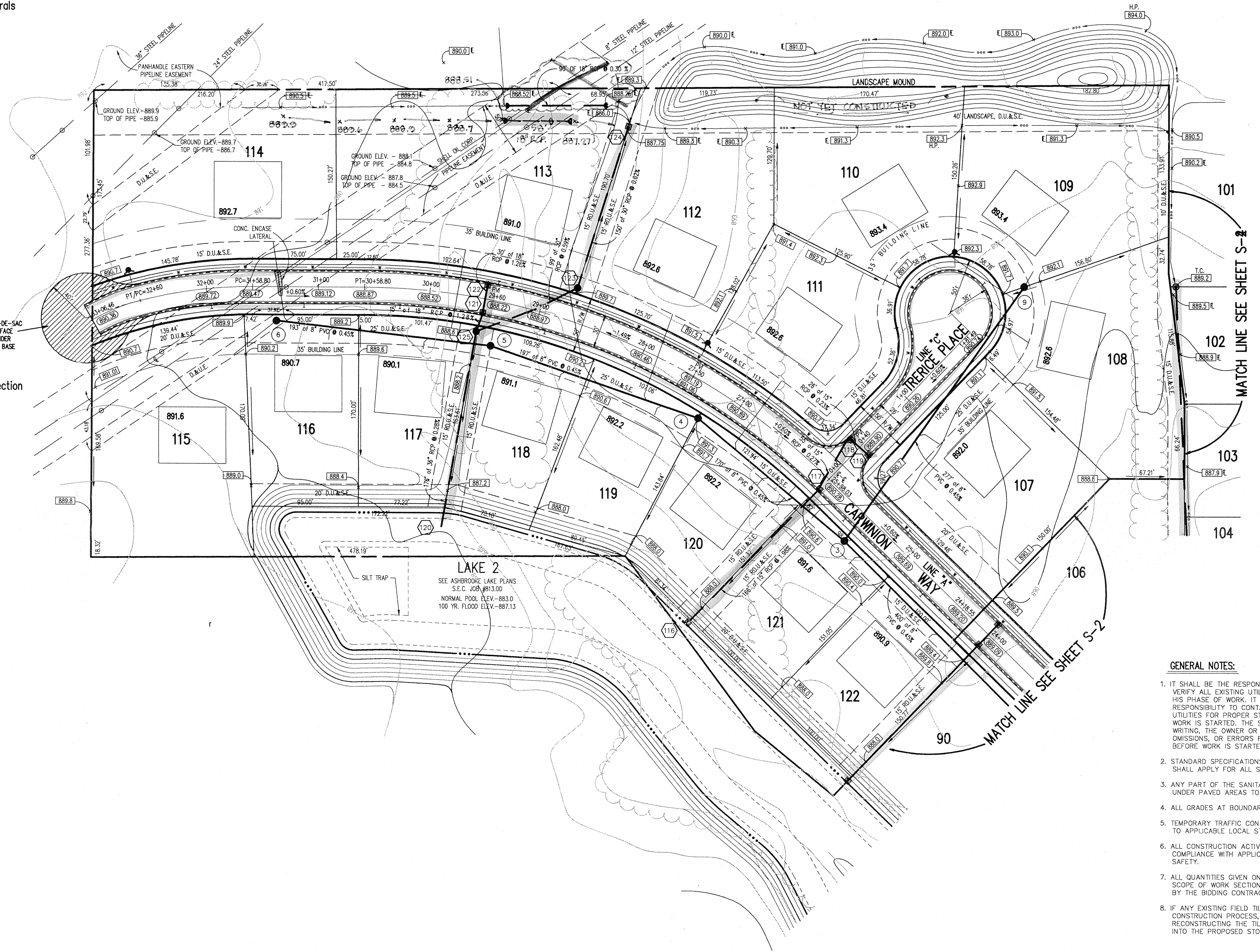

- GENERAL NOTES:**
1. IT SHALL BE THE RESPONSIBILITY OF EACH SUBCONTRACTOR TO VERIFY ALL EXISTING UTILITIES AND CONDITIONS PERTAINING TO HIS PHASE OF WORK. IT SHALL ALSO BE THE SUBCONTRACTOR'S RESPONSIBILITY TO CONTACT THE OWNERS OF THE VARIOUS UTILITIES FOR PROPER STAKE LOCATION OF EACH UTILITY BEFORE WORK IS STARTED. THE SUBCONTRACTOR SHALL NOTIFY, IN WRITING, THE OWNER OR THE ENGINEER OF ANY CHANGES, OMISSIONS, OR ERRORS FOUND ON THESE PLANS OR IN FIELD BEFORE WORK IS STARTED OR RESUMED.
  2. STANDARD SPECIFICATIONS FOR CLAY REGIONAL WASTE DISTRICT SHALL APPLY FOR ALL SANITARY SEWERS.
  3. ANY PART OF THE SANITARY OR STORM SEWER TRENCHES RUNNING UNDER PAVED AREAS TO BE BACKFILLED WITH GRANULAR MATERIAL.
  4. ALL GRADES AT BOUNDARY SHALL MEET EXISTING GRADES.
  5. TEMPORARY TRAFFIC CONTROL, CURING CONSTRUCTION TO CONFORM TO APPLICABLE LOCAL STANDARDS.
  6. ALL CONSTRUCTION ACTIVITY ON THIS SITE TO BE PERFORMED IN COMPLIANCE WITH APPLICABLE O.S.H.A. STANDARDS FOR WORKER SAFETY.
  7. ALL QUANTITIES GIVEN ON THE PRINTS, VERBALLY OR IN THE SCOPE OF WORK SECTION ARE ESTIMATES AND SHALL BE CONFIRMED BY THE BIDDING CONTRACTOR.
  8. IF ANY EXISTING FIELD TILE SYSTEMS ARE ENCOUNTERED DURING THE CONSTRUCTION PROCESS, THE CONTRACTOR SHALL BE RESPONSIBLE FOR RECONSTRUCTING THE TILE TO ITS ORIGINAL CONDITIONS OR CONNECT IT INTO THE PROPOSED STORM DRAINAGE SYSTEM.

**Benchmarks**  
**NOTE:**  
The elevation datum used for this project was formulated to coincide with topographic mapping created from aerial photography. This mapping was prepared by a consultant using an incorrect elevation value for US&GS Benchmark T-78. Since this mapping US&GS Benchmark T-78 has been destroyed. Previous surveys have established that a discrepancy existed between US&GS Benchmarks T-78 and S-78. The combination of these situations results in establishing an elevation datum based on an elevation value 1.12 feet greater than the published value for US&GS Benchmark S-78. The following benchmarks are established on site with values adjusted for use with this project only.

**TBM 101**  
Top of railroad spike in centerline of Shelbourne Road approximately 1335 feet south of the centerline of 106th Street.  
Elevation = 890.98

**TBM 102**  
Top of boat spike in centerline of Shelbourne Road approximately 2600 feet south of the centerline of 106th Street.  
Elevation = 885.42

**TBM 103**  
P.K. nail in west side of power pole 1 foot up on the east side of Shelbourne Road approximately 2600 feet south of the centerline of 106th Street.  
Elevation = 886.54

**TBM 104**  
A cut square at the southeast corner of the concrete deck of a lift station on the south side of the subject site approximately 1600 feet west of the centerline of Shelbourne Road.  
Elevation = 884.12



This information was gathered for input into the Hamilton County Geographical Information System. This document is considered an unrecorded record of the GIS.

Entry Date: 11-25-93

Entered by: JDH

**RECORD DRAWING**

PROJECT: ASHBOOKE SECTION 3 & 4  
JOB NO: 813.30  
PREPARED FOR: BRENNICK DEVELOPMENT CO., INC.  
TITLE: DEVELOPMENT PLAN

SCALE: 1"=50'

SHEET S-3 OF 16

SEP 09 1994  
OFFICE OF HAMILTON COUNTY SURVEYOR

DATE	BY	CHECK	REVISIONS
7/23/93	JDH	JDH	ADDED PIPE LOCATIONS/ELEVATIONS
4/17/93	JDH	JDH	ENGINEERING/DRAWING CHECK
5/17/93	JDH	JDH	REV. LOTS & NUMBERS
4/17/93	JDH	JDH	ADDED TEMP. D.U.-S&C
4/17/93	JDH	JDH	REVISED LINE & WEST END
4/17/93	JDH	JDH	REVISED STREET CALCULATION FROM 324.60 TO 341.06 & CARWINION WAY
1/28/94	JDH	JDH	ADDED PIPE ALONG N. SIDE OF LOT 113
7/14/94	JDH	JDH	REVISED
7/14/94	JDH	JDH	REVISED

CERTIFIED

**HOLEY MOLEY SAYS.**  
**"DON'T DIG BLIND"**



**1-800-382-5544**  
 CALL TOLL FREE  
**1-800-428-5200**  
 FOR CALLS OUTSIDE OF INDIANA

- GENERAL NOTES:
- ALL CUTS ARE TAKEN FROM THE EXISTING GRADE TO THE PIPE INVERT.
  - ALL STATIONING IS TAKEN FROM THE NEAREST DOWNSTREAM STRUCTURE.
  - IT SHALL BE THE CONTRACTORS RESPONSIBILITY TO FIELD VERIFY ALL UTILITY LOCATIONS BEFORE CONSTRUCTION BEGINS.
  - TEMPORARY TRAFFIC CONTROL DURING CONSTRUCTION TO CONFORM TO APPLICABLE LOCAL AND STATE STANDARDS.
  - ALL CONSTRUCTION ACTIVITY ON THIS SITE TO BE PERFORMED IN COMPLIANCE WITH APPLICABLE O.S.H.A. STANDARDS FOR WORKER SAFETY.
  - CONTRACTOR SHALL MINIMIZE DAMAGE TO EXISTING TREES.

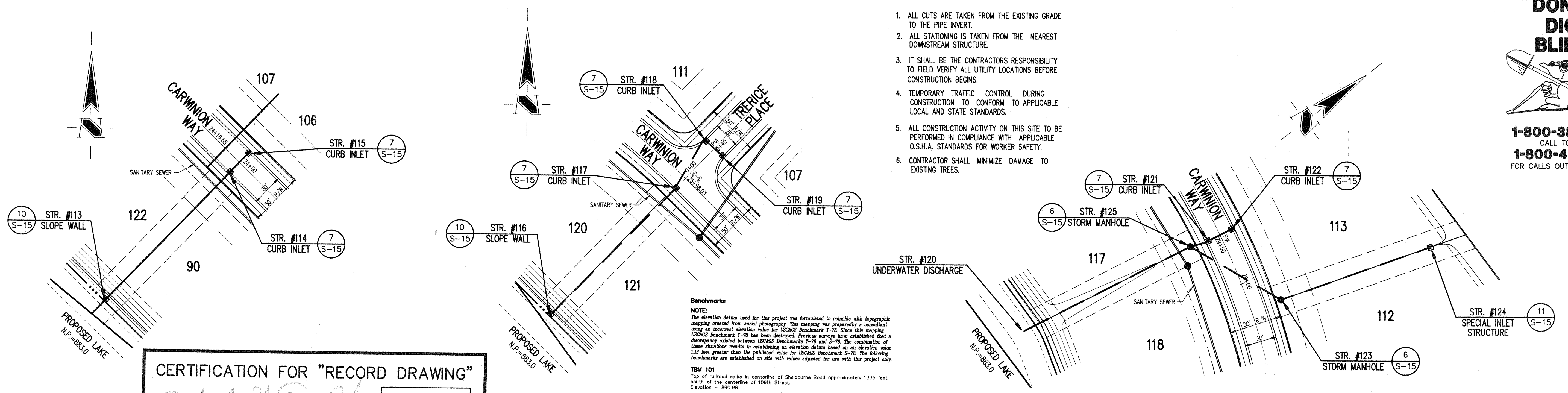

**CERTIFICATION FOR "RECORD DRAWING"**

CERTIFIED BY:  
*Richard G. Baiman*  
**SCHNEIDER ENGINEERING CORPORATION**  
 3020 NORTH POST ROAD  
 INDIANAPOLIS, INDIANA 46226-6518  
 P.O. BOX 26068 (317) 898-8282

NOTE:  
 Record drawing certification only for top of coating, invert elevations and lengths of pipe. Slope percentage represents a calculated figure and is for general information only.

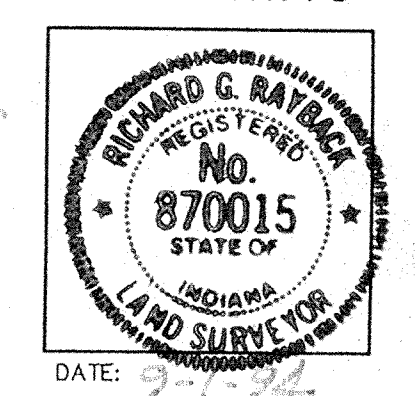

**Benchmarks**

NOTE:  
 The elevation datum used for this project was formulated to coincide with topographic mapping created from aerial photography. This mapping was prepared by a consultant using an incorrect elevation value for ISCAMS Benchmark T-78. Since the mapping (ISCAMS) Benchmark T-78 has been destroyed, previous surveys have established that a discrepancy existed between ISCAMS Benchmark T-78 and S-78. The combination of these situations results in establishing an elevation datum based on an elevation value 1.12 feet greater than the published value for ISCAMS Benchmark S-78. The following benchmarks are established on site with values adjusted for use with this project only.

**TBM 101**  
 Top of railroad spike in centerline of Shelburne Road approximately 1335 feet south of the centerline of 106th Street.  
 Elevation = 890.98

**TBM 102**  
 Top of boat spike in centerline of Shelburne Road approximately 2800 feet south of the centerline of 106th Street.  
 Elevation = 885.42

**TBM 103**  
 P.K. nail in west side of power pole 1 foot up on the east side of Shelburne Road approximately 2600 feet south of the centerline of 106th Street.  
 Elevation = 888.54

**TBM 104**  
 A cut square at the southeast corner of the concrete deck of a lift station on the south side of the subject site approximately 1600 feet west of the centerline of Shelburne Road.  
 Elevation = 884.12



This information was gathered for input into the Hamilton County Geographical Information System. This document is considered an official record of the GIS.

Entry Date: 11-25-88

Entered by: JCH

TOPOGRAPHY BY  
**LOBO AERIAL SURVEYS**  
 COLUMBUS, IN  
 DATED 12-23-88

**STORM SEWER PLAN**

SCALE: 1"=50'

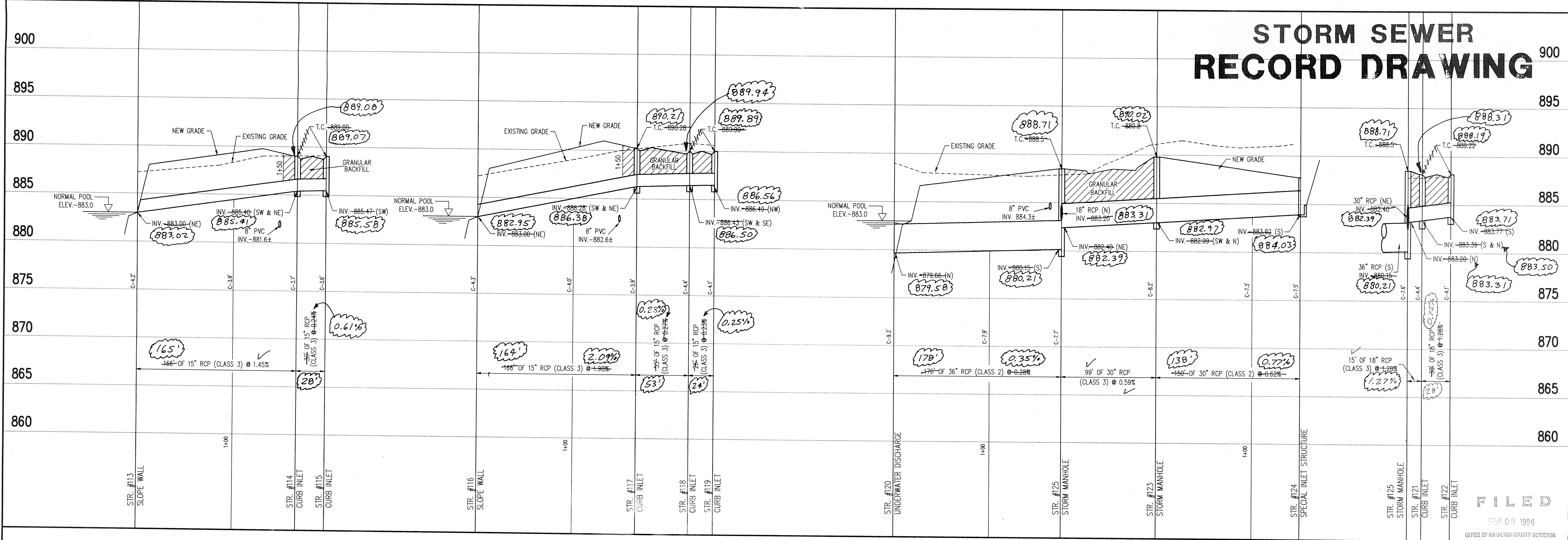

**STORM SEWER RECORD DRAWING**

**STORM SEWER PROFILE**

SCALE: HORZ.: 1"=50'  
 VERT.: 1"=5'

REVISIONS

NO.	DATE	BY	DESCRIPTION
1	11/23/88	JCH	ISSUED FOR PERMITS
2	12/23/88	JCH	ISSUED FOR RECORD

PROJECT: ASHBROOKE-SECTIONS 3 & 4  
 PREPARED FOR: BRENNICK DEVELOPMENT CO., INC.  
 TITLE: STORM SEWER PLAN

FILED  
 SEP 09 1994  
 OFFICE OF HAMILTON COUNTY SURVEYOR

SHEET S-14 OF 16  
 FILE NAME: 81335TMS

**CERTIFICATION FOR "RECORD DRAWING"**

CERTIFIED BY: *Richard G. Raylock*

**SCHNEIDER ENGINEERING CORPORATION**  
 3020 NORTH POST ROAD  
 INDIANAPOLIS, INDIANA 46228-6518  
 P.O. BOX 26068 (317) 898-8282

NOTE: Record drawing certification only for top of coating, invert elevations and lengths of pipe. Slope percentage represents a calculated figure and is for general information only.

DATE: 9-1-94

REGISTERED PROFESSIONAL LAND SURVEYOR  
 No. 870015  
 STATE OF INDIANA

**HOLEY MOLEY SAYS,**  
**"DON'T DIG BLIND"**

1-800-382-5544  
 CALL TOLL FREE  
 1-800-428-5200  
 FOR CALLS OUTSIDE OF INDIANA

TOPOGRAPHY BY  
**LOBO AERIAL SURVEYS**  
 COLUMBUS, IN  
 DATED 12-23-88

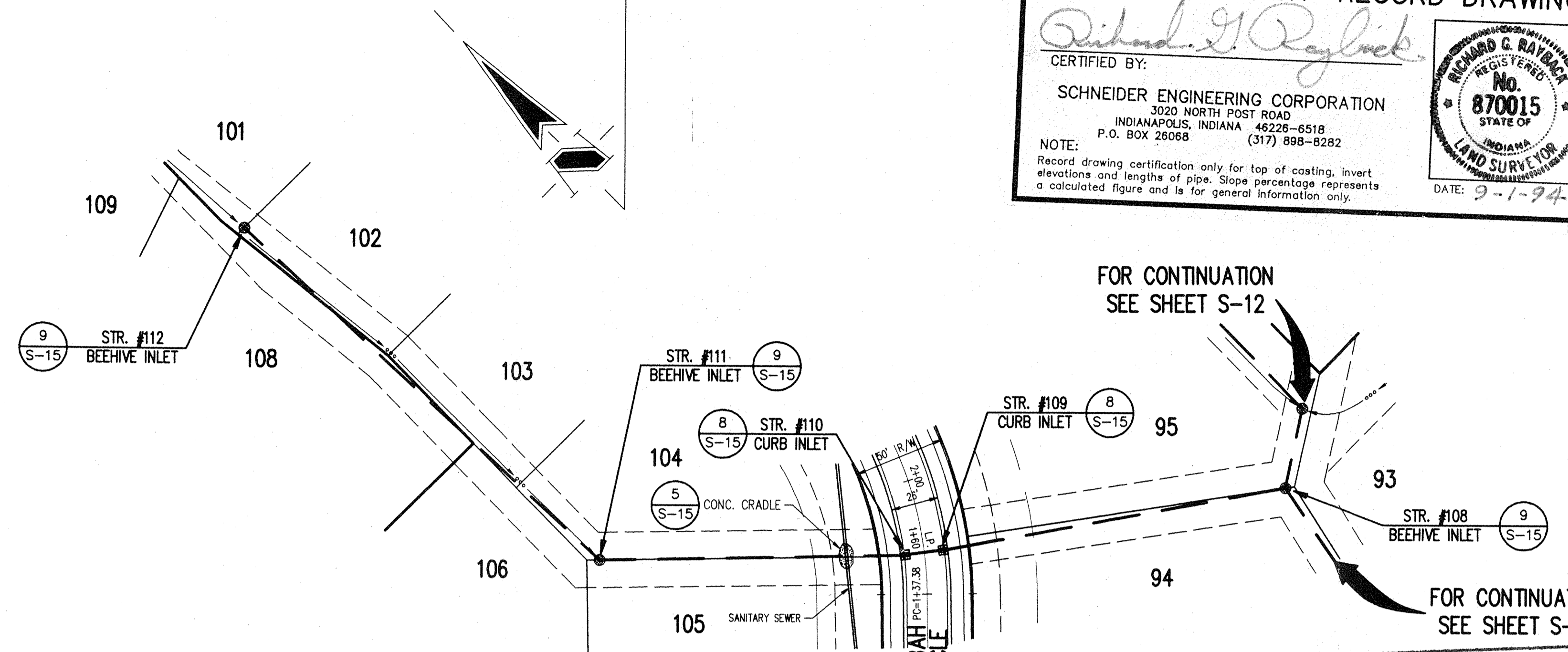

- GENERAL NOTES:**
1. ALL CUTS ARE TAKEN FROM THE EXISTING GRADE TO THE PIPE INVERT.
  2. ALL STATIONING IS TAKEN FROM THE NEAREST DOWNSTREAM STRUCTURE.
  3. IT SHALL BE THE CONTRACTOR'S RESPONSIBILITY TO FIELD VERIFY ALL UTILITY LOCATIONS BEFORE CONSTRUCTION BEGINS.
  4. TEMPORARY TRAFFIC CONTROL DURING CONSTRUCTION TO CONFORM TO APPLICABLE LOCAL AND STATE STANDARDS.
  5. ALL CONSTRUCTION ACTIVITY ON THIS SITE TO BE PERFORMED IN COMPLIANCE WITH APPLICABLE O.S.H.A. STANDARDS FOR WORKER SAFETY.
  6. CONTRACTOR SHALL MINIMIZE DAMAGE TO EXISTING TREES.

**Benchmarks**

NOTE: The elevation datum used for this project was formulated to coincide with topographic mapping created from aerial photography. This mapping was prepared by a contractor using an assumed elevation datum for USGS benchmarks 7-79. Since this mapping was prepared using a datum other than the published datum for USGS benchmarks 7-79, a discrepancy existed between USGS benchmarks 7-79 and 5-78. The combination of these elevations results in establishing an elevation datum based on an elevation value 1.12 feet greater than the published value for USGS benchmark 5-78. The following benchmarks are established on site with values adjusted for use with this project only.

**TBM 101**  
 Top of railroad spike in centerline of Shelbourne Road approximately 1335 feet south of the centerline of 106th Street.  
 Elevation = 890.98

**TBM 102**  
 Top of boat spike in centerline of Shelbourne Road approximately 2800 feet south of the centerline of 106th Street.  
 Elevation = 885.42

**TBM 103**  
 P.C. nail in west side of power pole 1 foot up on the east side of Shelbourne Road approximately 2000 feet south of the centerline of 106th Street.  
 Elevation = 886.54

**TBM 104**  
 A cut square at the southeast corner of the concrete deck of a lift station on the south side of the subject site approximately 1600 feet west of the centerline of Shelbourne Road.  
 Elevation = 884.12

INDIAN COUNTY  
 INDIANA  
 1823

This information was gathered for input into the Hamilton County Geographical Information System. This document is considered an official record of the GIS.

Entry Date: 11-25-92

Entered by: JPH

**STORM SEWER PLAN**

SCALE: 1"=50'

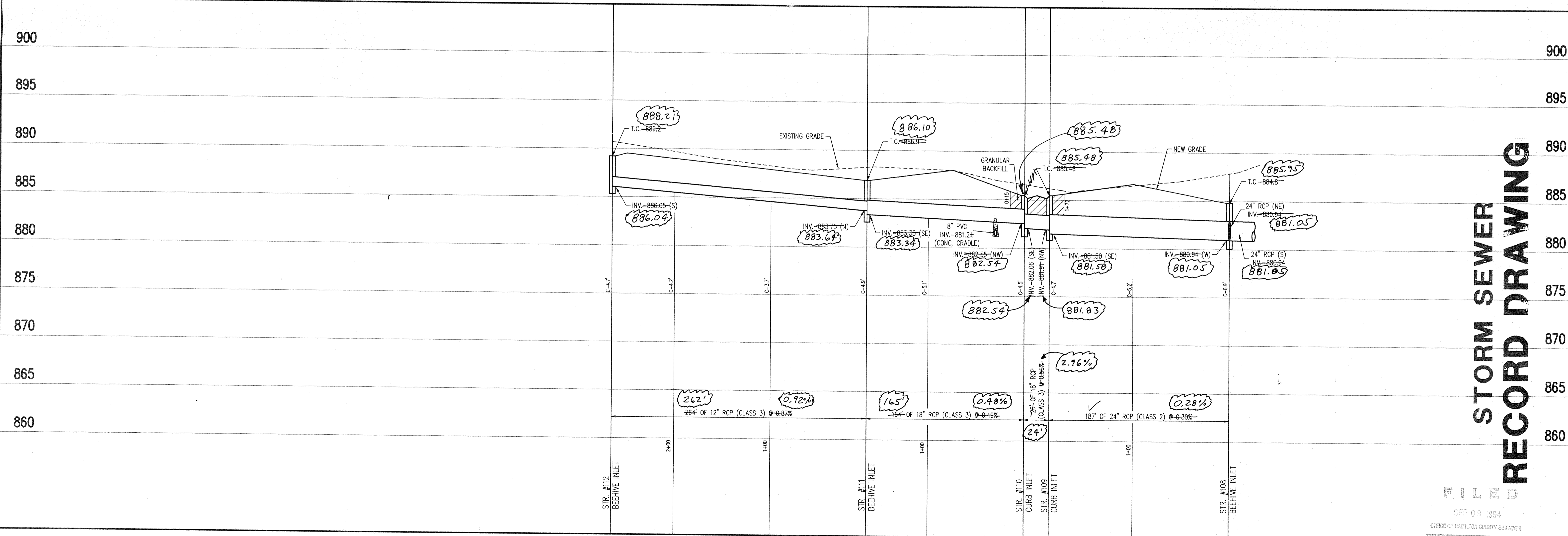

**STORM SEWER RECORD DRAWING**

PROJECT: ASHBROOKE - SECTIONS 3 & 4 JOB NO. 813.30

PREPARED FOR: BRENNICK DEVELOPMENT CO., INC.

TITLE: STORM SEWER PLAN

DATE: SEP 09 1994

OFFICE OF HAMILTON COUNTY SURVEYOR

SCHNEIDER ENGINEERING CORPORATION  
 Engineers  
 • Land Surveyors  
 • Civil Engineers  
 • Geologists

8845 EAST JEFFERSON AVENUE SUITE 200  
 INDIANAPOLIS, INDIANA 46228-6518  
 Telephone (317) 898-8282  
 Fax (317) 899-8010

FILED  
 SEP 09 1994  
 OFFICE OF HAMILTON COUNTY SURVEYOR

SHEET S-13 OF 16  
 FILE NAME: 81335T.M2



**HOLEY MOLEY SAYS.**  
**"DON'T DIG BLIND"**  
  
**1-800-382-5544**  
 CALL TOLL FREE  
**1-800-428-5200**  
 FOR CALLS OUTSIDE OF INDIANA

TOPOGRAPHY BY  
**LOBO AERIAL SURVEYS**  
 COLUMBUS, IN  
 DATED 12-23-88

REVISIONS	DATE	BY	CHECK
1	12/23/88	JDH	JDH
2	1/27/89	JDH	JDH
3	2/24/89	JDH	JDH
4	3/2/89	JDH	JDH
5	3/2/89	JDH	JDH
6	3/2/89	JDH	JDH
7	3/2/89	JDH	JDH
8	3/2/89	JDH	JDH
9	3/2/89	JDH	JDH
10	3/2/89	JDH	JDH
11	3/2/89	JDH	JDH
12	3/2/89	JDH	JDH
13	3/2/89	JDH	JDH
14	3/2/89	JDH	JDH
15	3/2/89	JDH	JDH
16	3/2/89	JDH	JDH
17	3/2/89	JDH	JDH
18	3/2/89	JDH	JDH
19	3/2/89	JDH	JDH
20	3/2/89	JDH	JDH

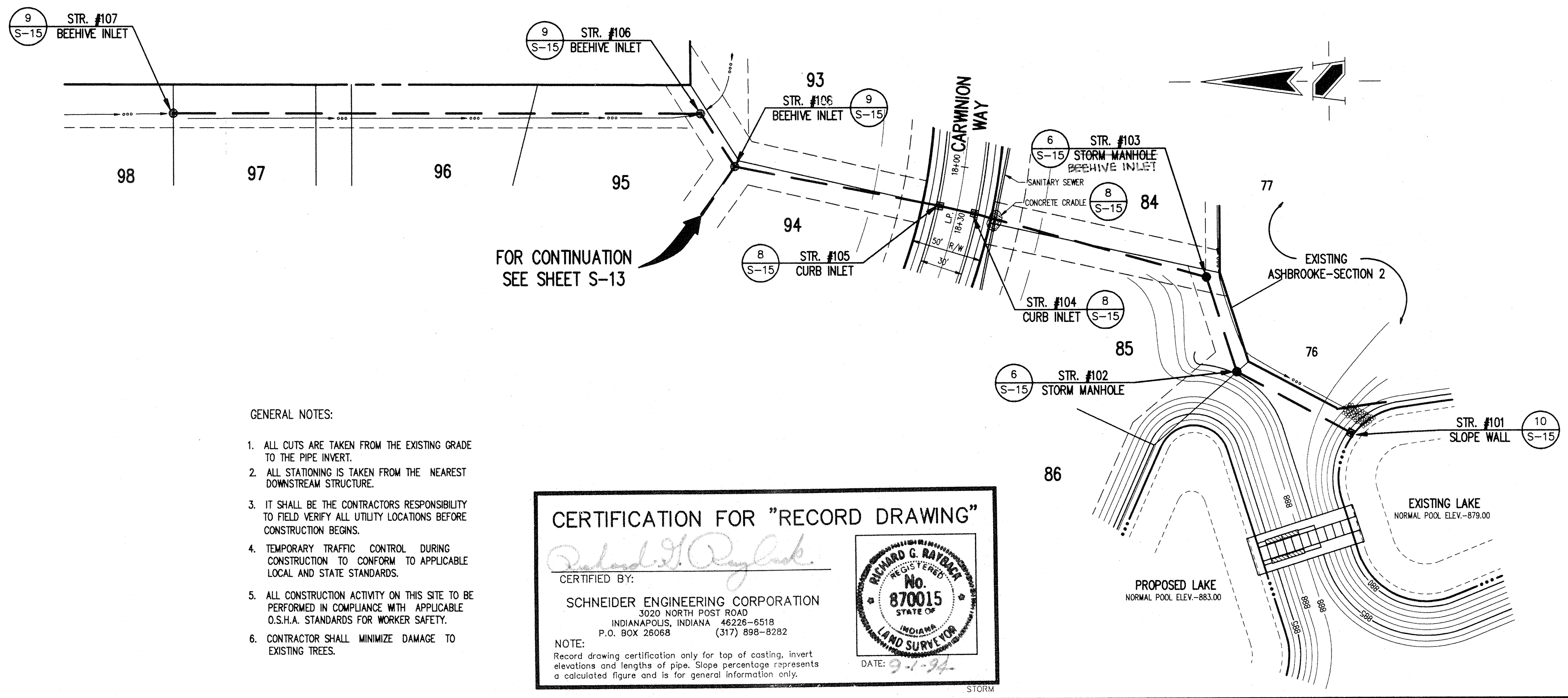

**CERTIFICATION FOR "RECORD DRAWING"**

CERTIFIED BY:  
*Richard C. Rabbar*  
 SCHNEIDER ENGINEERING CORPORATION  
 3020 NORTH POST ROAD  
 INDIANAPOLIS, INDIANA 46226-6518  
 P.O. BOX 26068 (317) 898-8282

NOTE:  
 Record drawing certification only for top of coating, invert elevations and lengths of pipe. Slope percentage represents a calculated figure and is for general information only.

DATE: 9-1-94

INDIANA LAND SURVEYOR No. 870015

- GENERAL NOTES:
- ALL CUTS ARE TAKEN FROM THE EXISTING GRADE TO THE PIPE INVERT.
  - ALL STATIONING IS TAKEN FROM THE NEAREST DOWNSTREAM STRUCTURE.
  - IT SHALL BE THE CONTRACTORS RESPONSIBILITY TO FIELD VERIFY ALL UTILITY LOCATIONS BEFORE CONSTRUCTION BEGINS.
  - TEMPORARY TRAFFIC CONTROL DURING CONSTRUCTION TO CONFORM TO APPLICABLE LOCAL AND STATE STANDARDS.
  - ALL CONSTRUCTION ACTIVITY ON THIS SITE TO BE PERFORMED IN COMPLIANCE WITH APPLICABLE O.S.H.A. STANDARDS FOR WORKER SAFETY.
  - CONTRACTOR SHALL MINIMIZE DAMAGE TO EXISTING TREES.

**Benchmarks**

NOTE:  
 The elevation datum used for this project was formulated to coincide with topographic mapping created from aerial photography. This mapping was prepared by a consultant using an incorrect elevation value for IGCAS Benchmark 7-78. Since this mapping (IGCAS Benchmark 7-78) has been destroyed, traverse surveys have established that a discrepancy existed between IGCAS Benchmarks 7-78 and S-78. The combination of these situations results in establishing an elevation datum based on an elevation value 1.12 feet greater than the published value for IGCAS Benchmark S-78. The following benchmarks are established on site with values adjusted for use with this project only.

TBM 101  
 Top of railroad spike in centerline of Shelbourne Road approximately 1335 feet south of the centerline of 106th Street.  
 Elevation = 890.98

TBM 102  
 Top of foot spike in centerline of Shelbourne Road approximately 2800 feet south of the centerline of 106th Street.  
 Elevation = 885.42

TBM 103  
 P.K. nail in west side of power pole 1 foot up on the east side of Shelbourne Road approximately 2800 feet south of the centerline of 106th Street.  
 Elevation = 885.54

TBM 104  
 A cut square at the southeast corner of the concrete deck of a lift station on the south side of the subject site approximately 1500 feet west of the centerline of Shelbourne Road.  
 Elevation = 884.12

**STORM SEWER PLAN**

SCALE: 1"=50'

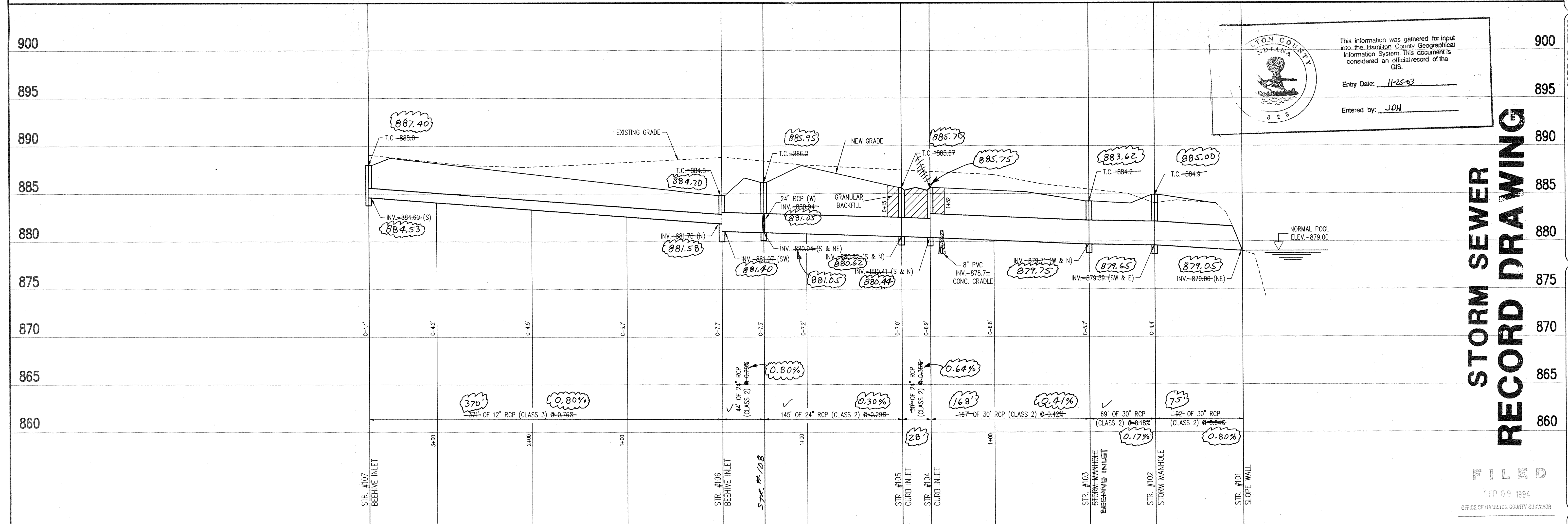

ION COUNTY INDIANA

This information was gathered for input into the Hamilton County Geographical Information System. This document is considered an official record of the GIS.

Entry Date: 11-25-03

Entered by: JDH

**STORM SEWER RECORD DRAWING**

PROJECT: ASHBROOKE - SECTION 3 & 4  
 JOB NO. 813.30  
 PREPARED FOR: BRENNICK DEVELOPMENT CO., INC.  
 TITLE: STORM SEWER PLAN

SCHNEIDER ENGINEERING CORPORATION  
 Professional Engineers  
 Land Surveyors  
 Land Planners  
 Geologists

3020 NORTH POST ROAD  
 INDIANAPOLIS, INDIANA 46226-6518  
 DANVILLE, INDIANA 46122  
 Telephone (317) 898-8282  
 Fax (317) 898-8010

FILED  
 SEP 09 1994  
 OFFICE OF HAMILTON COUNTY SURVEYOR

**STORM SEWER PROFILE**

SCALE: HORZ.: 1"=50'  
 VERT.: 1"=5'